

PLAN SHOWING THE PROPOSED CONSTRUCTION OF RESIDENTIAL BUILDING AT PLOT NO 45&46(Part) MOHANAPURI 3RD CROSS STREET, PANJAB NAGAR, ADAMBAKKAM, CHENNAI - 600088
OLD S.NO.574/1A1A APT (As per Patta)
T.S NO 13/1 AND 14, BLOCK NO.128
OF VELACHERI VILLAGE, VELACHERI TALUK, CHENNAI DISTRICT

GREATER CORPORATION OF CHENNAI, DIVISION NO.177 - PART 40A, ZONE : XIII
Area Statement. (sqm)
Plot Area (As Per Docu) 557.41
Plot Area (As Per site) 84.5 x 56 544.28
Plot Area (As Per patta) 549.00

Floor Detail	F.S.I Area	F% of production
Still floor area		
First floor area	203.33	9.64
Second floor area	203.33	9.64
Third floor area	203.33	9.64
Fourth floor area	203.33	9.64
Total floor area	813.32	39.55
F.S.I	813.32	
F.S.I Achieved	544.28	1.484

Car Parking Required - 9 No's
Car Parking Achieved - 9 No's

Specifications.

Foundation	: Column footing foundation.
Flooring	: Ceramic tile Flooring
Super Structure	: B.W in C.M 1:5
R.C.C Work	: For lintel, Beams, sunshade, Roof, etc., with required thickness cement concrete used M-25 grade
Weathering course	: Brick jelly lime conc. below the weathering tiles
Joinery	: Best Indian Country Wood
Finishes	: Exterior & interior painted with cement paint.

SCHEDULE OF JOINERIES

MD36	1.07 X 2.13	Main Door
D3	0.91 X 2.13	Door
D26	0.76 X 2.13	Door
FW1	1.79 X 1.98	French Window
W3	0.91 X 1.37	Window
W4	1.22 X 1.37	Window
W6	1.83 X 1.37	Window
KW3	0.91 X 1.07	Kitchen Window
KW4	1.22 X 1.07	Kitchen Window
V2	0.61 X 0.91	Ventilator

All Dimensions are in Metre.
Scale : 1:100

Colour Index

Proposed	▬
Boundary	▬
Road	▬

North
W —+— E
S

Owner's Signature

Architect Signature

SIVA ANBARASAN
M.Arch (U.S.A., England), A.I.I.A.,
Regd. Architect, C.A. No. 10769, R.A. No. 191
S3, IInd Floor, 43, Pantheon Road, Egmore,
Chennai-6. Ph: 28554262, 28410888

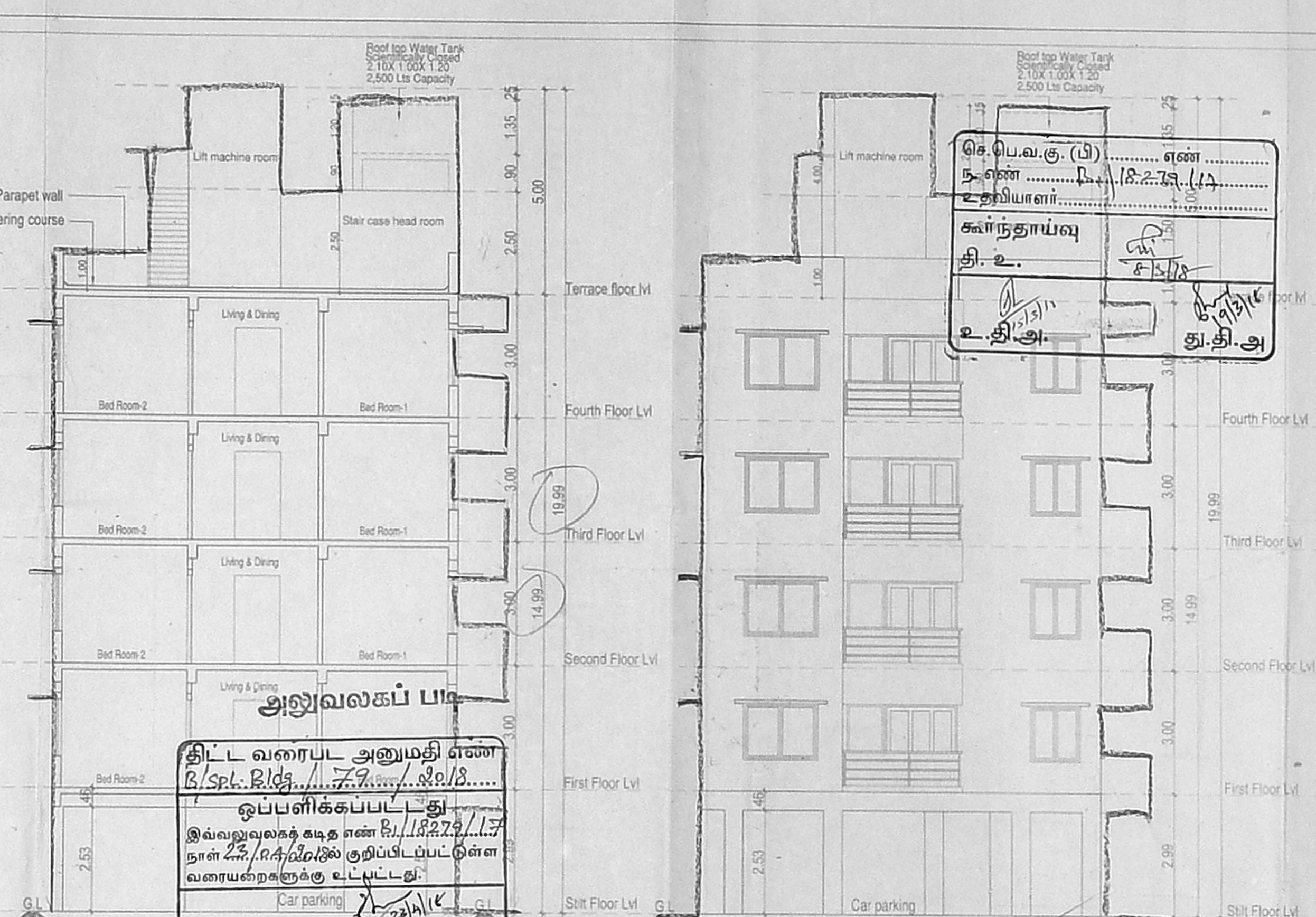
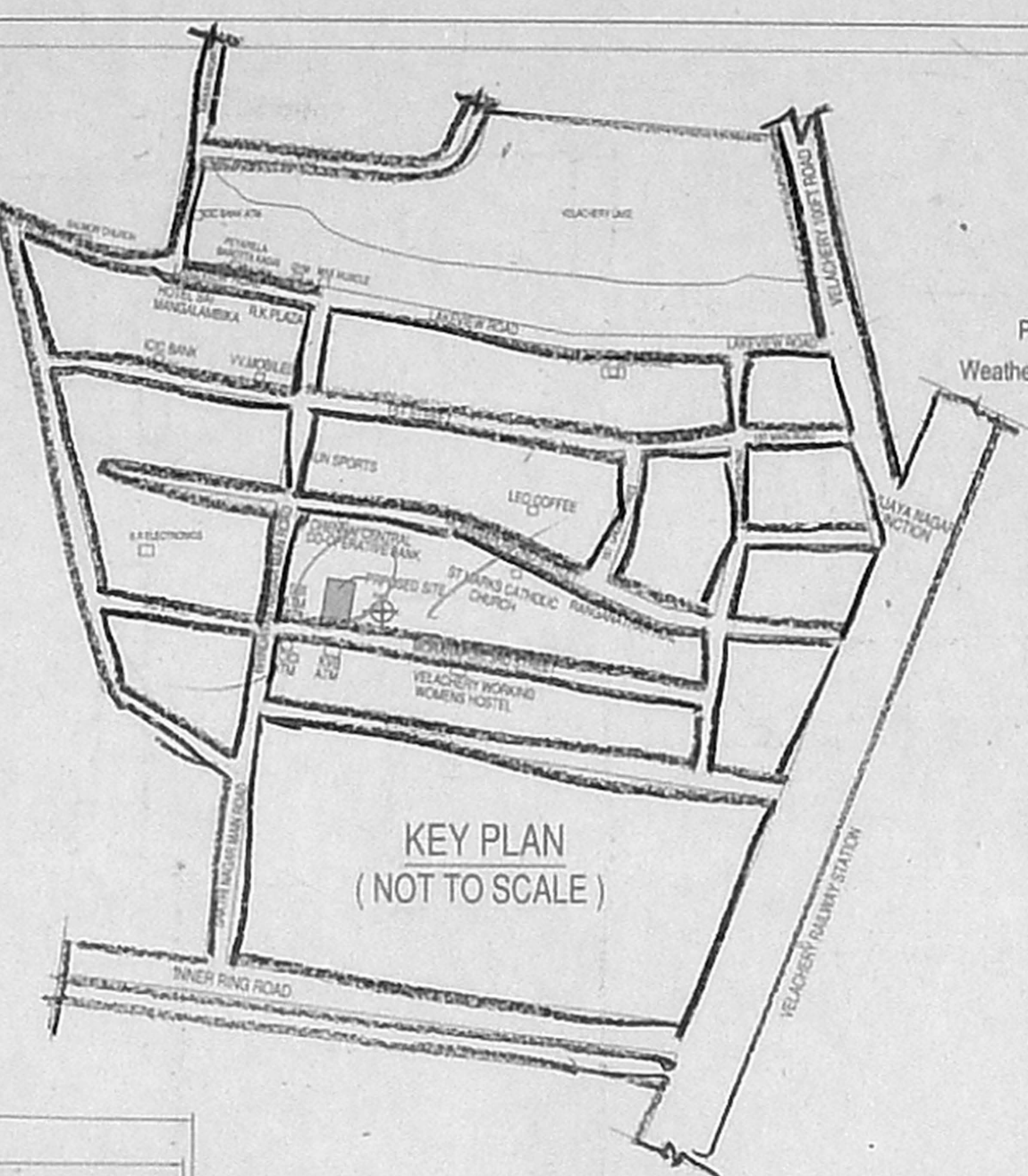
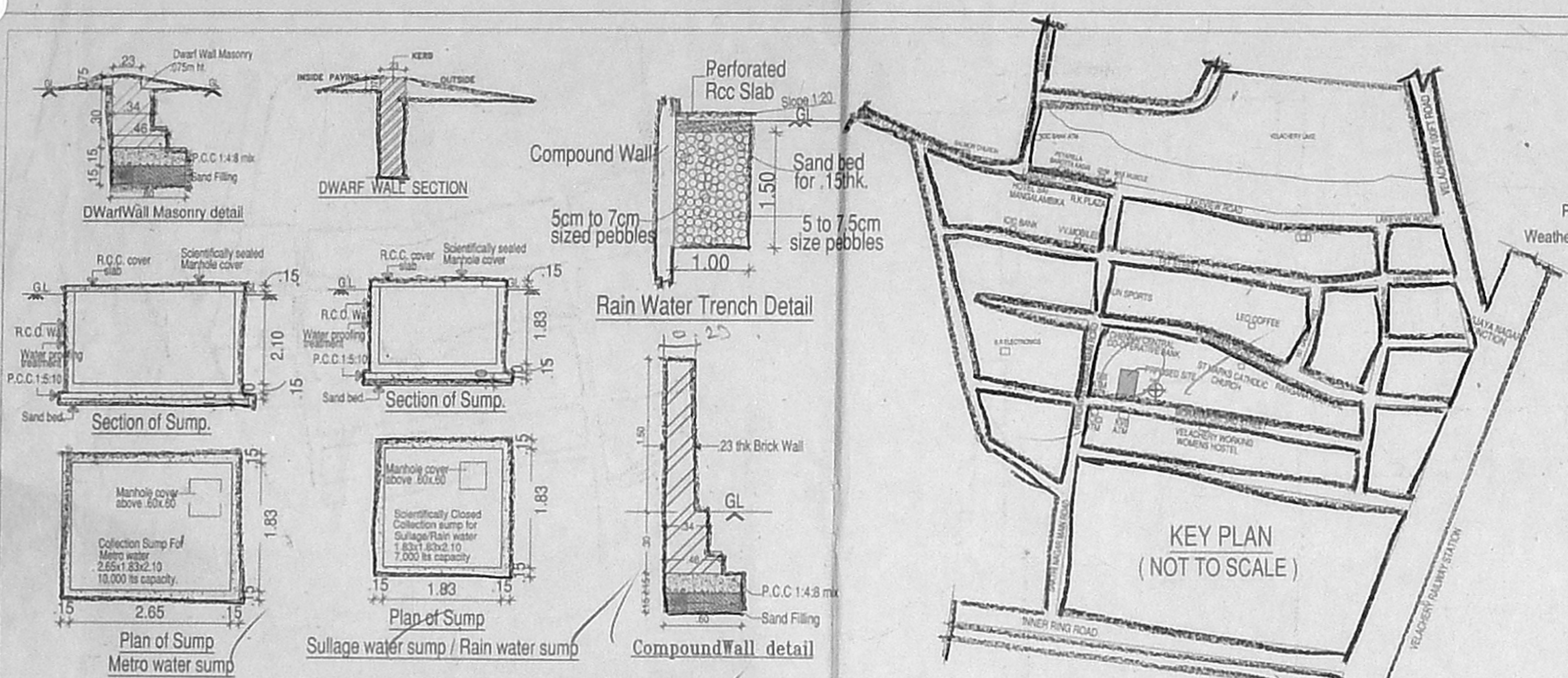

திட்ட வரைபட அனுமதி எண்
B/S.P.L. No. 79/18.2.2.1.1.3
நாள் 22/12/2018
இவ்வவரைபடத்தை உட்படிந்து
உறப்பினர் செயலாக்காக
சென்னைப் பெருநகர் வளர்ச்சி குழுமம்,
சென்னை - 600 008.

